

REV AK

DIMENSIONS ARE IN INCHES		UNLESS OTHERWISE NOTED		TITLE:	DWG NO:
TOLERANCES ARE:		TOLERANCES ARE:		AP ASSEMBLY	APX-XXX-X-X
ONE PLACE DECIMALS ±	THREE PLACE DECIMALS ±	ANGLES ±			
TWO PLACE DECIMALS ±	FOUR PLACE DECIMALS ±				SHEET 1 OF 2

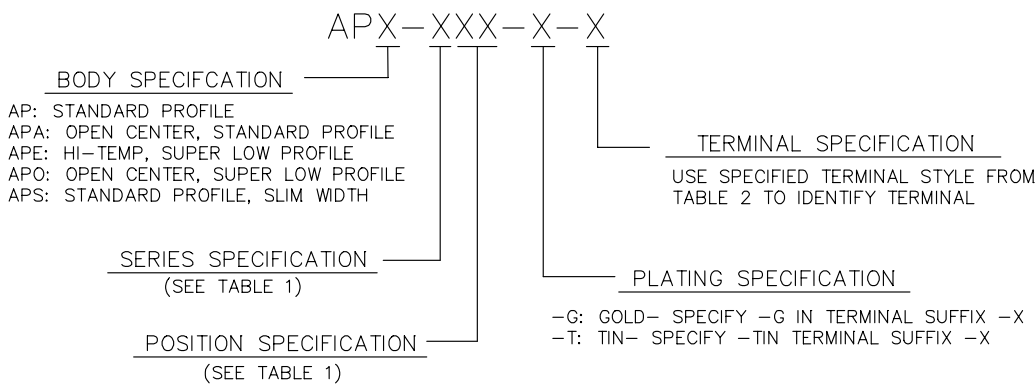

- NOTES:
- MINIMUM PUSHOUT FORCES:
 AP ASSEMBLY: 12 LBS.
 APA ASSEMBLY: 5 LBS.
 APE ASSEMBLY: 10 LBS.
 APO ASSEMBLY: 5 LBS.
 APS ASSEMBLY: 12 LBS.
 - MAXIMUM ALLOWABLE BOW:
 .003 INCH PER INCH.
 - (C) REPRESENTS A CRITICAL DIMENSION
 - HEIGHT VARIATION TO BE .010 [.25] MAX BETWEEN ROWS (SEE SHEET 2).
 - PACKAGE APX-3XX WITH LEAD STYLES M, N, P, & Q IN PT-1-24-01-56 TUBE WITH TWO TP-28 PLUGS PER TUBE.
 - PACKAGE APX-6XX-X-Q IN PT-1-24-02-56 TUBE WITH TWO TP-04 PLUGS PER TUBE.
 - PACKAGE APX-6XX-X-P IN PT-1-24-03-56 TUBE WITH TWO TP-28 PLUGS PER TUBE.
 - PACKAGE APX-6XX-X-M & APA-6XX-X-N IN PT-1-24-04-56 TUBE WITH TWO TP-25 PLUGS PER TUBE.

TABLE 1 (* : CUT TO LENGTH IN FIG.1)

SERIES	POSITION	AP	APA	APE	APO	APS
-3	06	SB-306	N/R	N/R	N/R	SBS-308*
	08	SB-308	SBOA-308	N/R	SBO-308	SBS-308
	10	SB-314*	N/R	N/R	N/R	SBS-314*
	12	N/R	N/R	N/R	N/A	N/R
	14	SB-314	SBOA-314	SBE-314	SB0-314	SBS-314
	16	SB-316	SBOA-316	SBE-316	SB0-316	SBS-316
	18	SB-318	SBOA-318	SBE-318	SB0-318	SBS-318
	20	SB-320	SBOA-320	N/R	SB0-320	SB-320
	22	N/R	SBOA-324*	N/R	SB0-324*	N/R
	24	SB-324	SBOA-324	N/R	SB0-324	SB-324
-4	28	N/R	ICA-328-V	N/R	N/R	N/R
	22	SB-422	SBOA-422	N/R	SB0-422	SB-422
-6	24	SB-424	N/R	N/R	N/A	N/R
	10	SB-614*	N/R	N/R	N/R	N/R
	14	SB-614	N/R	N/R	N/R	N/R
	16	SB-616	N/R	N/R	N/R	N/R
	18	SB-618	N/R	N/R	N/R	N/R
	20	N/R	N/R	N/R	N/R	N/R
	22	N/R	N/R	N/R	N/R	N/R
	24	SB-624	SBOA-624	SBE-624	SB0-624	SBS-624
	28	SB-628	SBOA-628	SBE-628	SB0-628	SBS-628
	32	SB-640*	SBOA-632	N/R	SB0-632	SBS-632
-9	40	SB-640	SBOA-640	SBE-640	SB0-640	SBS-640
	48	N/R	SBOA-648	SBE-648	N/R	N/R
	14	N/R	N/R	N/R	N/R	N/R
	24	N/R	N/R	N/R	N/R	N/R
	28	N/R	N/R	N/R	N/R	N/R
	32	N/R	N/R	N/R	N/R	N/R
	40	SB-964*	N/R	N/R	N/R	N/R
	48	N/R	N/R	N/R	N/R	N/R
	50	SB-964*	N/R	N/R	N/R	N/R
	64	SB-964	N/R	SBE-964	N/R	N/R

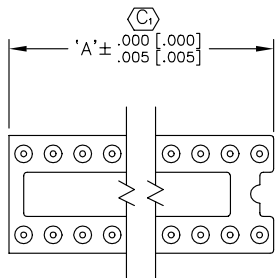

FIGURE 1

REF. PART No.	'A'	
AP-310-XXX	.535±.005	13.59±.005
AP-610-XXX	.500	12.70
AP-632-XXX	1.600	40.64
AP-940-XXX	2.000	50.80
AP-950-XXX	2.500	63.50
APA-322-XXX	1.100	27.94
APO-312-XXX	.600	15.24
APO-322-XXX	1.100	27.94
APS-306-XXX	.340	8.64 ±.005 [.13]
APS-310-XXX	.500	12.70

PROPRIETARY NOTE
 THIS DOCUMENT CONTAINS INFORMATION CONFIDENTIAL AND PROPRIETARY TO SAMTEC INC. AND SHALL NOT BE REPRODUCED OR TRANSFERRED TO OTHER DOCUMENTS OR DISCLOSED TO OTHERS OR USED FOR ANY PURPOSE OTHER THAN THAT FOR WHICH IT WAS OBTAINED WITHOUT THE EXPRESSED WRITTEN CONSENT OF SAMTEC INC.

DWG\MISC\MKTG
APX-MKT

samtec

520 PARK EAST BLVD. NEW ALBANY, INDIANA 47150
 PHONE (812) 944-6733 P.O. BOX 1147
 CODE 55322

MADE BY: YINGLING 4-20-85

APX-XXX-X-X
SHEET 1 OF 2

TABLE 2 TERMINAL SPECIFICATION

TERMINAL STYLE	AP, APA, APS	FIG.	APE	FIG.	APO	FIG.
A	T-1R0-X	1	T-1R0-X	10	T-1R0-X	10
A1	T-1R5-X	1	T-1R5-X	10	T-1R5-X	10
* A2	T-1R7-2-X	-	N/R	-	N/R	-
* A3	T-1R7-3-X	-	N/R	-	N/R	-
B	T-1R1-X	2	T-1R1-X	11	T-1R1-X	11
* B1	T-1R8-1-X	-	N/R	-	N/R	-
* B2	T-1R8-2-X	-	N/R	-	N/R	-
* B3	T-1R8-3-X	-	N/R	-	N/R	-
C	T-1R2-X	3	T-1R2-X	12	T-1R2-X	12
* C1	T-1R9-1-X	-	N/R	-	N/R	-
* C2	T-1R9-2-X	-	N/R	-	N/R	-
* C3	T-1R9-3-X	-	N/R	-	N/R	-
D	T-1S4-1-1-X	4	T-1S4-1-1-X	13	N/R	-
* D1-2	T-1S4-1-2-X	-	N/R	-	N/R	-
* D2-1	T-1S4-2-1-X	-	N/R	-	N/R	-
* D2-2	T-1S4-2-2-X	-	N/R	-	N/R	-
* D3-1	T-1S4-3-1-X	-	N/R	-	N/R	-
* D3-2	T-1S4-3-2-X	-	N/R	-	N/R	-
* D4-1	T-1S4-4-1-X	-	N/R	-	N/R	-
* D4-2	T-1S4-4-2-X	-	N/R	-	N/R	-
E	T-1S5-X	5	N/R	-	N/R	-
F	T-1S2-X	6	N/R	-	N/R	-
H	N/R	-	T-1R6-X	10	T-1R6-X	10
J	S-1P1-X	7	S-1P1-X	14	S-1P1-X	14
K	T-1R15-X	8	N/R	-	N/R	-
** M	T-1R14-1	9	N/R	-	N/R	-
** N	T-1R14-2	9	N/R	-	N/R	-
** P	T-1R14-3	9	N/R	-	N/R	-
** Q	T-1R14-4	9	N/R	-	N/R	-
R	N/R	-	T-2R6-X	10	T-2R6-X	10
T	N/R	-	T-3R6-X	10	T-3R6-X	10

* NOT RELEASED

** NOT AVAILABLE IN
APA-328-X-X

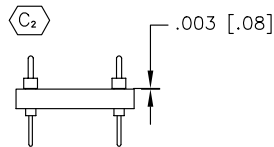

FIG. 10

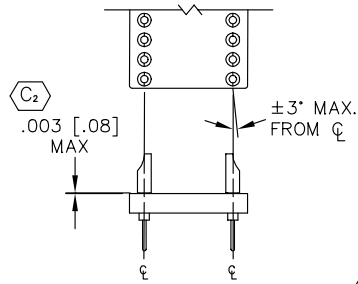

FIG. 11

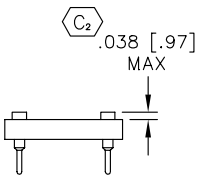

FIG. 14

PROPRIETARY NOTE
THIS DOCUMENT CONTAINS INFORMATION CONFIDENTIAL AND PROPRIETARY TO SAMTEC INC. AND SHALL NOT BE REPRODUCED OR TRANSMITTED TO OTHER DOCUMENTS OR DISCLOSED TO OTHERS OR USED FOR ANY PURPOSE OTHER THAN THAT FOR WHICH IT WAS OBTAINED WITHOUT THE EXPRESSED WRITTEN CONSENT OF SAMTEC INC.

DIMENSIONS ARE IN INCHES		UNLESS OTHERWISE NOTED		TOLERANCES ARE:		TITLE:	DWG NO:
ONE PLACE DECIMALS ±	THREE PLACE DECIMALS ±	ANGLES ±				AP ASSEMBLY	APX-XXX-X-X
TWO PLACE DECIMALS ±	FOUR PLACE DECIMALS ±						SHEET 2 OF 2

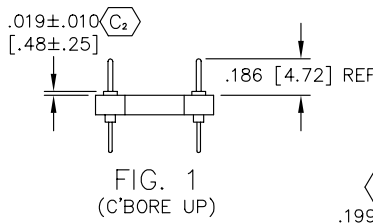

FIG. 1
(C'BORE UP)

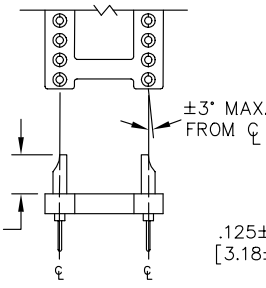

FIG. 2
(C'BORE UP)

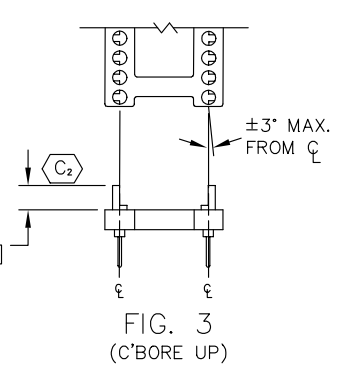

FIG. 3
(C'BORE UP)

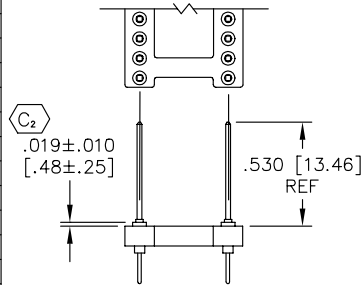

FIG. 4
(C'BORE UP)

.025 SQ TAILS TO BE ORIENTED AS SHOWN

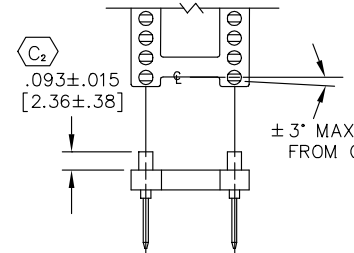

FIG. 5
(C'BORE UP)

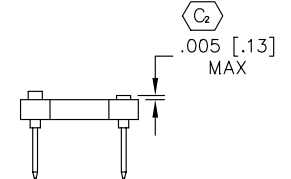

FIG. 6
(C'BORE UP)

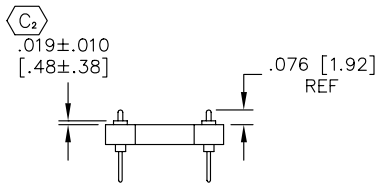

FIG. 8
(C'BORE UP)

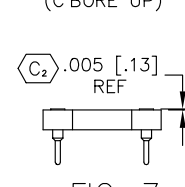

FIG. 7
(C'BORE UP)

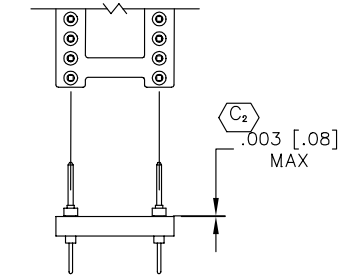

FIG. 13

.025 SQ TAILS TO BE ORIENTED AS SHOWN

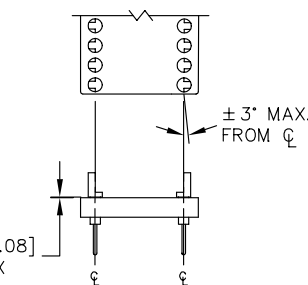

FIG. 12

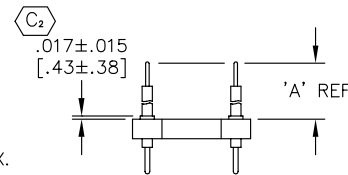

FIG. 9
(C'BORE UP)

LEAD STYLE	'A'	
-M	.202	[5.13]
-N	.327	[8.31]
-P	.577	[14.66]
-Q	.827	[21.01]

NOTE:
HEIGHT VARIATION TO BE .010 MAX BETWEEN ROWS.

samtec

520 PARK EAST BLVD. NEW ALBANY, INDIANA 47150
PHONE (812) 944-6733 P.O. BOX 1147
CODE 55322

DWG/MISC/MKT
APX-2MK

MADE BY:

APX-XXX-X-X
SHEET 2 OF 2